



The Knightswood

2 bedroom semi-detached home

Whitsbury Green | Whitsbury Road | Fordingbridge | SP6 1NQ



The Knightswood

Standard Layout Plots: 59

Handed Plot: 58

 x2  x2

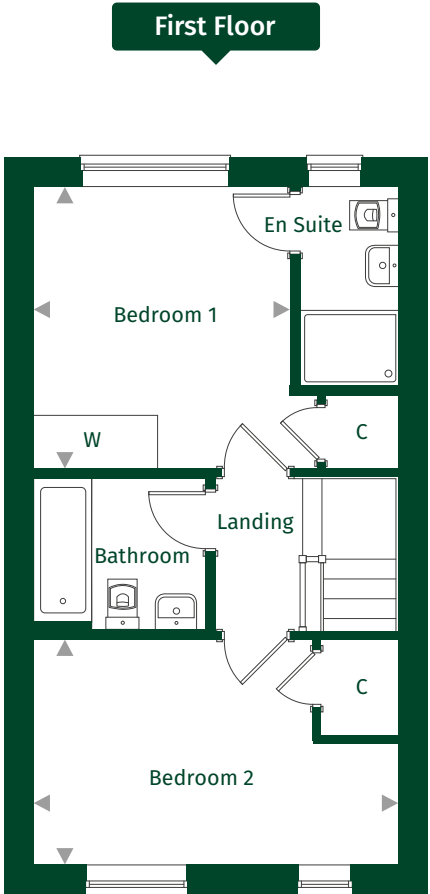
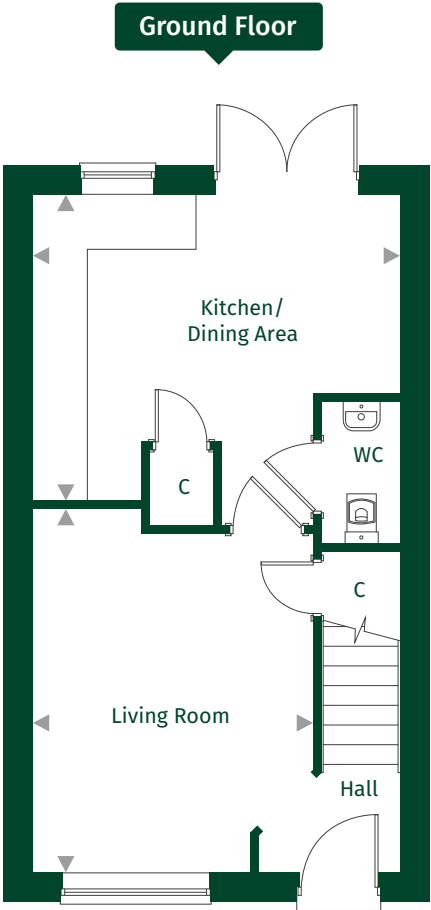

Kitchen/Dining Area	4.38m x 3.06m	14'4" x 10'0"
Living Room	4.05m x 3.36m	13'3" x 10'11"

Bedroom 1	3.36m x 3.06m	11'0" x 10'0"
Bedroom 2	4.38m x 2.70m	14'4" x 8'10"

Key:

◀ ▶ Maximum dimension C = Cupboard W = Wardrobe

For full details please contact our Sales Team:

Call: 01425 541818 | **Email:** whitsburygreen@pennyfarthinghomes.co.uk | **Website:** pennyfarthinghomes.co.uk

Floorplans and CGIs are indicative only. The floor plans illustrate a typical layout of this house type. For exact plot specification, details of external and internal finishes, dimensions and floor plan differences please speak to a Sales Adviser. Correct at time of going to print, November 2023.