



POTTERS
WOOD

The Hatchwood

Three bedroom semi-detached house with garage.



Computer Generated Image.



[Floor plans and dimensions >](#)

The Hatchwood

See separate site plan for plot locations.

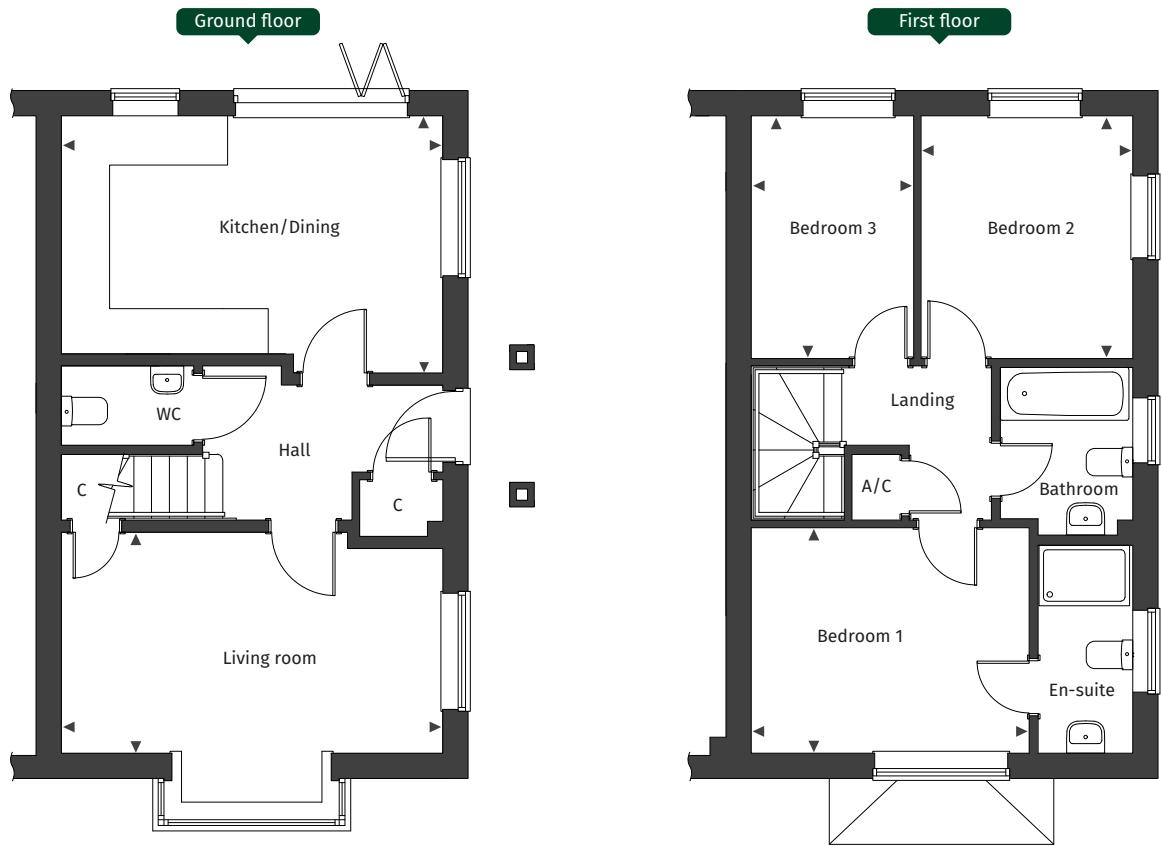

Floor plans are not to scale.

The Hatchwood plot number

264

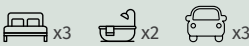

Ground floor

Kitchen/Dining	5.04m x 3.40m / 16' 6" x 11' 2"
Living room	5.04m x 2.99m / 16' 6" x 9' 9"

First floor

Bedroom 1	3.68m x 2.99m / 12' 0" x 9' 9"
Bedroom 2	2.80m x 3.32m / 9' 2" x 10' 10"
Bedroom 3	2.14m x 3.32m / 7' 0" x 10' 10"

◀ ▶ Maximum dimension A/C Airing Cupboard C Cupboard

The CGI image depicted is an artistic representation of a standard house type. Actual building plots may vary in terms of orientation, topography, landscaping, neighbouring structures, and other site-specific factors. Buyers should refer to detailed site plans, elevations, and architectural specifications for accurate information regarding individual plots and as built.